

## ***SAFETY AND CAUTIONS***

In order to ensure vehicle safety, the driver should not operate i-Hub while driving.

## ***WARNING***

To avoid electrical shock or bodily harm, please ensure the following:

1. Please do not use the unit if it is defective.
2. Please do not use the unit in an environment with mist, dust, and fuel vapours.
3. Please do not provide the unit with voltage exceeding the marked range.

## ***EMERGENCY HANDLING***

If the machine is exhibiting unusual behaviour, please turn off its power quickly and contact our service centre for support. Please do not attempt to repair the unit yourself, so as to prevent any danger.

## ***TABLE OF CONTENTS***







<b>Introduction &amp; Product Indicators.....</b>	<b>1</b>
<b>Hardware Wiring.....</b>	<b>2</b>
<b>Remote Controller Guide.....</b>	<b>3</b>
<b>Software Operation.....</b>	<b>4</b>
<b>Specification Table &amp; Compatibility Table.....</b>	<b>6</b>

## **INTRODUCTION**

### **Contents in the HiLink i-Hub carton box**

When you open the product carton, you should find the following parts in your possession.

#### **Main Components**

- A. i-Hub (main unit) 
- B. iPod Data Convertor 
- C. iPod Connection Cable 
- D. Remote IR eye 
- E. Remote Control (1 x CR2025 battery included) 
- F. External RCA Input   
(For extra external A/V input)

#### **Extra Connecting Components for HiTV Tuner**

- G. External IR eye Connection Cable 

#### **User Manual & Warranty Card**

- H. User Manual & Warranty Card

## HARDWARE WIRING

i-Hub installation / Installing i-Hub with HiTV TV Tuner

**CAUTION:** Please complete the hardware wiring before power up the unit.

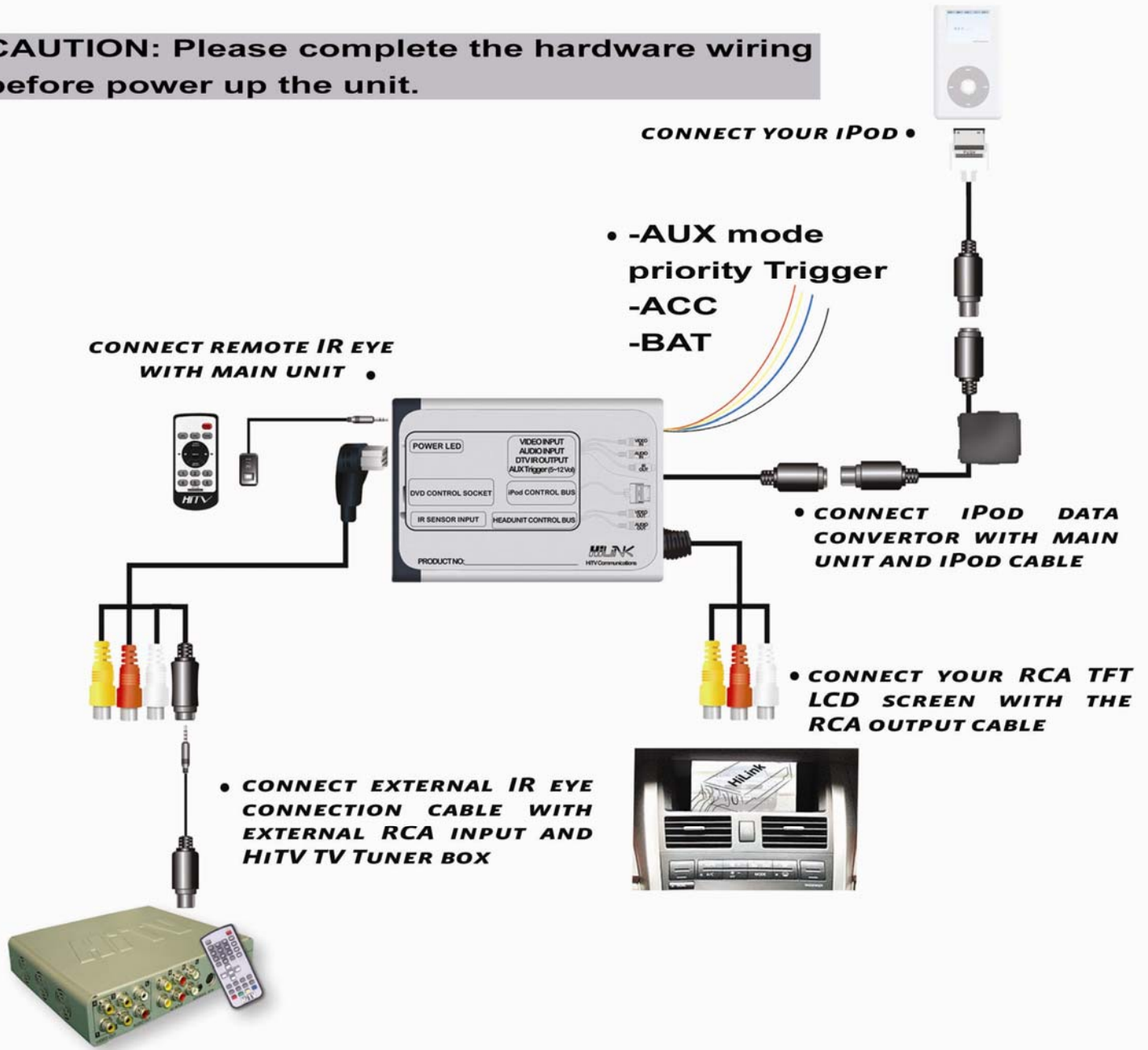

- When a HiTV Tuner has already been installed and connected with HiLink i-Hub, only the i-Hub IR eye is required to remote control both of HiTV Tuner and iPod.

## REMOTE CONTROLLER GUIDE



To display opinions from iPod Music  
 <List Songs>  
 <Folder Select>  
 <Sortation>



To fast rewind playing songs/movie in <iPod Music> and <iPod Video> mode



>To replay the playing song  
 >To play the previous song  
 >To go to the previous page in menu



To play songs randomly



To start searching songs while song playing in <iPod Music> mode



To change background colour



To switch between <iPod Music> <iPod Video> <DVD/DTV>



To fast forward playing songs/movie in <iPod Music> and <iPod Video> mode



To activate/confirm the selected item



>To play the next song  
 >To go to the next page in menu



To play / pause songs / movies



To move the cursor upward / downward / left / right in the list

# SOFTWARE OPERATION

## <IPOD MUSIC> MODE (FULL CONTROL MUSIC DECK)

**<IPOD MUSIC> MODE RETRIEVES IPOD AUDIO DATA AND DISPLAYS ONTO LCD. DIRECT IPOD OPERATION BECOMES DYSFUNCTIONAL ONCE IN <IPOD MUSIC> MODE. IPOD MUSIC CONTROLLING WOULD RELY ON I-HUB REMOTE CONTROL.**

### Getting Started

To	Do
Get started	Simply connect iPod to the iPod Connection Cable. <iPod Music> mode will be displayed on the LCD screen. The last played song in iPod will be played automatically.

### Songs Operating During Song Playing

To	Do
Fast rewind the playing song	Press <b>REW</b> button on the remote control. Press <b>PLAY/PAUSE</b> button to play songs in normal speed.
Fast forward the playing song	Press <b>FORW</b> button on the remote control. Press <b>PLAY/PAUSE</b> button to play songs in normal speed.
Pause the playing song	Press <b>PLAY/PAUSE</b> button on the remote control <u>once</u> . Press <b>PLAY/PAUSE</b> button again to continue playing music.
Restart the playing song	Press <b>LEFT</b> button on the remote control <u>once</u> .
Listen to the previous song	Press <b>LEFT</b> button on the remote control <u>twice</u> .
Listen to the next song	Press <b>NEXT</b> button on the remote control.
Search song with song's no	Press <b>SEARCH</b> button on the remote control. Press <b>UP</b> , <b>DOWN</b> , <b>LEFT</b> or <b>RIGHT</b> button to select the track no. Press <b>ENTER</b> button to confirm and play selected song.

### Folders Selecting During Song Playing

To	Do
List songs in same folder	Press <b>MENU</b> button on the remote control <u>once</u> . <iPod Songs> screen will be displayed.
List different folders in iPod	Press <b>MENU</b> button on the remote control <u>twice</u> . <Folder Select> screen will be displayed. Press <b>LEFT</b> or <b>RIGHT</b> button to scroll to previous/next folder page. Press <b>UP</b> or <b>DOWN</b> button to choose a folder. Press <b>ENTER</b> button to open the selected folder.
List all types of song folders	Press <b>MENU</b> button on the remote control <u>three times</u> . <Sortation> screen will be displayed. Press <b>UP</b> or <b>DOWN</b> button to choose a folder. Press <b>ENTER</b> button to open the selected folder.

### Random Playing

To	Do
Play songs randomly	Press <b>SHUFFLE</b> button on the remote control <u>once</u> . Press <b>LEFT</b> or <b>RIGHT</b> button for random play within the same folder. Press <b>UP</b> or <b>DOWN</b> button for all-folder combined random play. Press <b>SHUFFLE</b> button again to resume to normal play.

### Volume Adjusting

To	Do
Adjust music volume	In <iPod Music> mode, volume can be adjusted from head unit volume buttons.

### Power Charging

To	Do
Recharge iPod	Once iPod connected with HiTV i-Hub, it is recharged automatically.

## SOFTWARE OPERATION

### <IPOD VIDEO> MODE (MOVIE PLATFORM)

**<IPOD VIDEO> MODE RETRIEVES IPOD VIDEO DATA AND DISPLAYS ONTO LCD. BOTH DIRECT IPOD OPERATION AND I-HUB REMOTE CONTROL BECOME FUNCTIONAL ONCE IN <IPOD VIDEO> MODE.**

#### Getting Started

To	Do
Get started	<p>Before connect iPod to the iPod Connection Cable, turn "ON" TV Out in your iPod. (Video&gt;Video Settings&gt;TV Out)</p> <p>Connect iPod to the iPod Connection Cable. &lt;iPod Music&gt; mode will be displayed on the LCD screen.</p> <p>Press <b>MODE</b> button on the remote control <u>once</u> to toggle from &lt;iPod Music&gt; to &lt;iPod Video&gt; mode. Choose and play the desired movie from the iPod operating pad.</p>

#### Movies Operating During Movies Playing

To	Do
Fast rewind the playing movie	<p>Press <b>REW</b> button on the remote control.</p> <p>Press <b>PLAY/PAUSE</b> button to play movies in normal speed.</p> <p>/ OR use iPod Click Wheel to fast rewind and play.</p>
Fast forward the playing movie	<p>Press <b>FORW</b> button on the remote control.</p> <p>Press <b>PLAY/PAUSE</b> button to play movies in normal speed.</p> <p>/ OR use iPod Click Wheel to fast forward and play.</p>
Pause the playing movie	<p>Press <b>PLAY/PAUSE</b> button on the remote control <u>once</u>.</p> <p>Press <b>PLAY/PAUSE</b> button again to continue playing the movie.</p> <p>/ OR use iPod Click Wheel to pause and play.</p>
Watch different movies	Use iPod Click Wheel to select the desired movie.

#### Volume Adjusting

To	Do
Adjust movie volume	In <iPod Video> mode, volume can be adjusted by using iPod Click Wheel.

#### Power Charging

To	Do
Recharge iPod	Once iPod connected with HiTV i-Hub, it is recharged automatically.

### <DVD / DTV> MODE (EXTENDED MEDIA)

**<DVD / DTV> MODE RETRIEVES DVD, DIGITAL TV OR OTHER EXTENDED MEDIA DATA AND DISPLAYS ONTO LCD.**

**IN DIGITAL TV MODE, HiTV TV TUNER REMOTE CONTROL BECOMES FUNCTIONAL. I-HUB IR EYE IS CAPABLE FOR RECEIVING THE SIGNALS FROM HiTV TV TUNER REMOTE CONTROL.**

#### Getting Started

To	Do
Get started	<p>Connect iPod to the iPod Connection Cable. &lt;iPod Music&gt; mode will be displayed on the LCD screen.</p> <p>Press <b>MODE</b> button on i-Hub remote control <u>twice</u> to toggle from &lt;iPod Music&gt; to &lt;DVD / DTV&gt; mode. &lt;DVD / DTV&gt; mode will be displayed on the LCD screen.</p>

## ***SPECIFICATION & COMPATIBILITY TABLE***

### ***INTERFACE SPECIFICATION***

Power Supply : DC12V  
Power Required : DC 10V ~ DC16V  
Consumer Current : 1.5A (DC12V Standard)  
Operating Temperature : -10°C ~ +65°C  
Storage Temperature : -20°C ~ +85°C  
Size : 112mm (W) x 28mm (H) x 78mm (L)

### ***VIDEO SPECIFICATION***

Video Input : Composite x 1 set, 75Ω Impedance  
Video Output : Composite x 1 set, 75Ω Impedance  
Video System : NTSC

### ***AUDIO SPECIFICATION***

Audio Input : Stereo input L/R x 1 set  
Audio Output : Stereo output I/R x 1 set

### ***COMPATIBILITY TABLE***

i-Hub is eligible for any TFT LCD screen with composite inputs.

HiLink i-Hub is an in-car media hub that  
combines iPod MUSIC, iPod  
VIDEO, Digital TV and DVD

Driving will never be the same from now on